

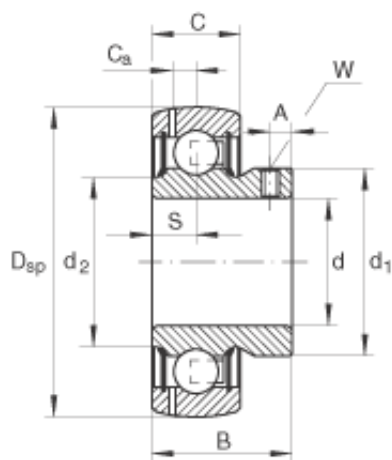

New energy Bearing Manufacturing Co.,...



INA GAY45-NPP-B deep groove ball bearings

Bearing No. GAY45-NPP-B

| | |
|----------------------|--|
| Size | 45x85x41.5 mm |
| Bore Diameter | 45 mm |
| Outer Diameter | 85 mm |
| Width | 41,5 mm |
| d | 45 mm |
| D _{SP} | 85 mm |
| B | 41,5 mm |
| A | 8 mm |
| C | 22 mm |
| C _a | 6,4 mm |
| d ₁ | 57 mm |
| d ₂ | 54,3 mm |
| S | 11 mm |
| W | 4 mm |
| m | 0,6 kg / Weight |
| C _r | 34500 N / Dynamic load rating (radial) |
| C _{0r} | 20400 N / Static load rating (radial) |
| Category | Insert Bearings Spherical OD |
| Inventory | 0.0 |
| Manufacturer Name | SCHAEFFLER GROUP |
| Minimum Buy Quantity | N/A |
| Weight / Kilogram | 0 |
| EAN | 4012802037913 |
| Product Group | M06110 |

GAY45-NPP-B Bearing 2D drawings and 3D CAD models



New energy Bearing Manufacturing Co.,...

| | |
|--------------------------|---|
| Inner Race Profile | Narrow Inner Ring |
| Outer Race Profile | Spherical |
| Relubricatable | Yes |
| Seal Type | Double Lip Contact |
| Mounting Method | Set Screw |
| Rolling Element | Ball Bearing |
| Snap Ring | No |
| Long Description | 45MM Bore; Narrow Inner Ring; Ball Bearing; 41.5MM Length Thru Bore; 22MM Outer Race Width; 85MM Outside Diameter; Relubricatable; Double Lip Contact Seal; Set Screw Mounting Method; No Snap Ring |
| Inch - Metric | Metric |
| Other Features | Single Row Grub Screw Metric |
| Category | Insert Bearings |
| UNSPSC | 31171536 |
| Harmonized Tariff Code | 8482.10.50.00 |
| Noun | Bearing |
| Keyword String | Insert |
| Manufacturer URL | http://www.ina.com |
| Manufacturer Item Number | GAY45NPPB |
| Weight / LBS | 1.213 |
| Length Thru Bore | 1.634 Inch 41.5 Millimeter |
| Outside Diameter | 3.346 Inch 85 Millimeter |
| Bore | 1.772 Inch 45 Millimeter |
| Outer Race Width | 0.866 Inch 22 Millimeter |