

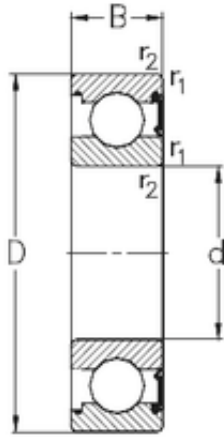

New energy Bearing Manufacturing Co.,...



65 mm x 120 mm x 23 mm NKE 6213-RSR deep groove ball bearings

Bearing No. 6213-RSR

Size	65x120x23 mm
Bore Diameter	65 mm
Outer Diameter	120 mm
Width	23 mm
d	65 mm
D	120 mm
B	23 mm
C	23 mm
r1 min.	1,5 mm
r2 min.	1,5 mm
Weight	0,982 Kg
Basic dynamic load rating (C)	57 kN
Basic static load rating (C0)	40 kN

6213-RSR Bearing 2D drawings and 3D CAD models