

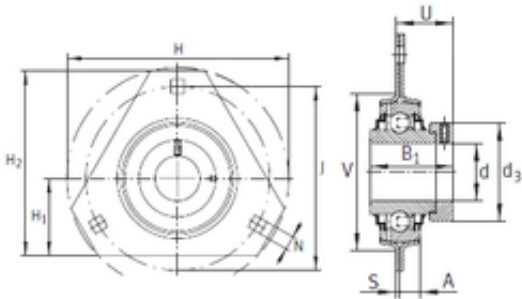

New energy Bearing Manufacturing Co.,...

INA RRTR35 bearing units



Bearing No. RRTR35

Bore Diameter	35 mm
d	35 mm
S1	2,5 mm
V	81 mm
U	34,8 mm
d3	51 mm
A	9,5 mm
B1	51,3 mm
H	122 mm
H1	44,5 mm
H2	105,6 mm
J	100 mm
N	10,5 mm

RRTR35 Bearing 2D drawings and 3D CAD models